

## eSIM Installation

I have other devices that can scan QR code.

# Before Going Abroad Installation

The eSIM installation requires a network. It is recommended to find a stable WiFi or mobile data to install eSIM before departure.

### 1 Go to Settings > Cellular

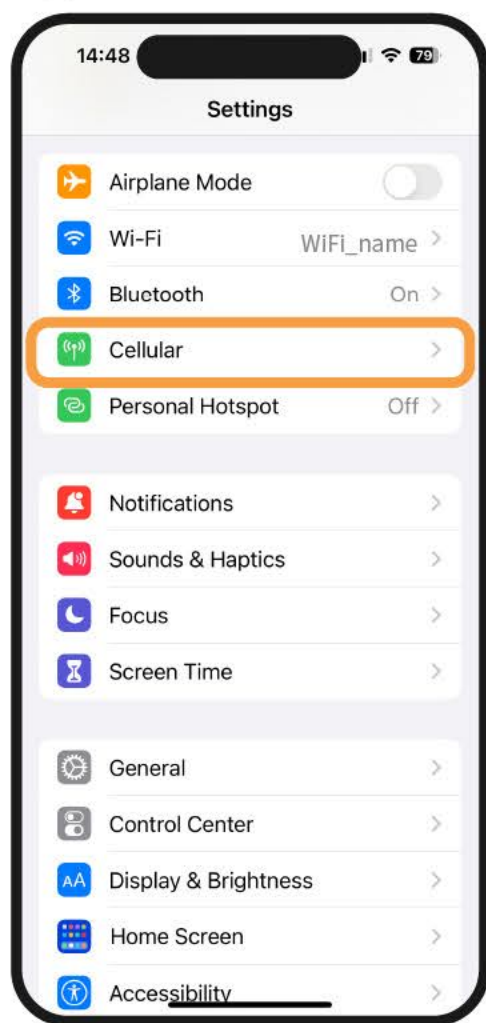

### 2 Add eSIM



### 3 Scan QRcode

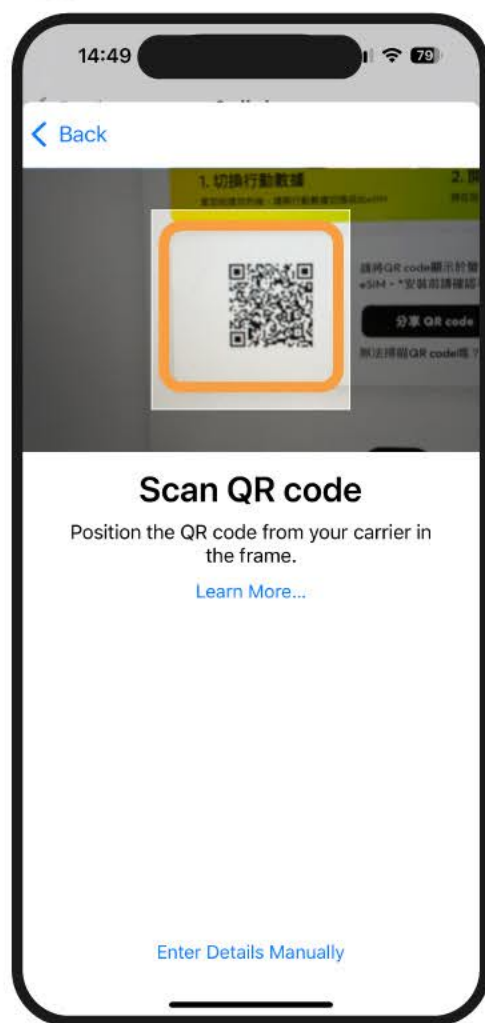

### 4 Activate eSIM



### 5 Press Continue

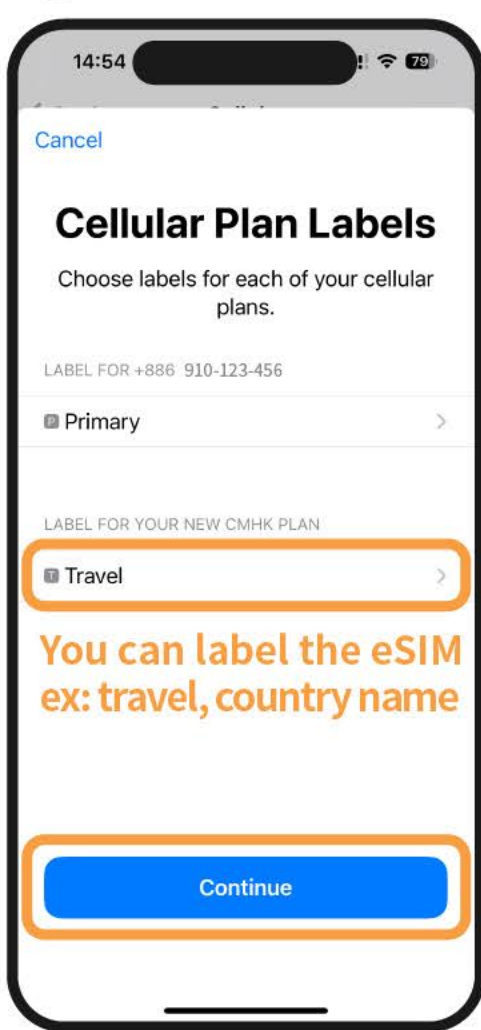

### 6 Choose Default Line

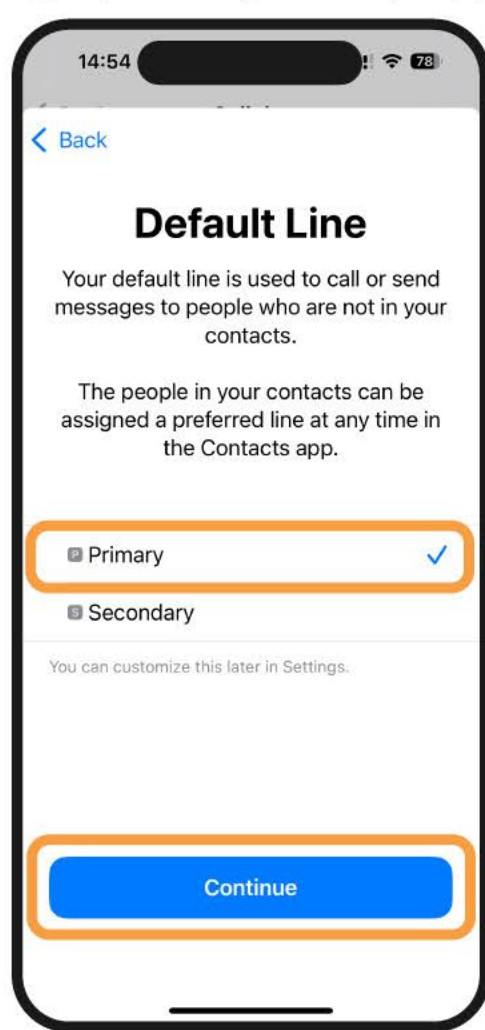

### 7 Choose Primary

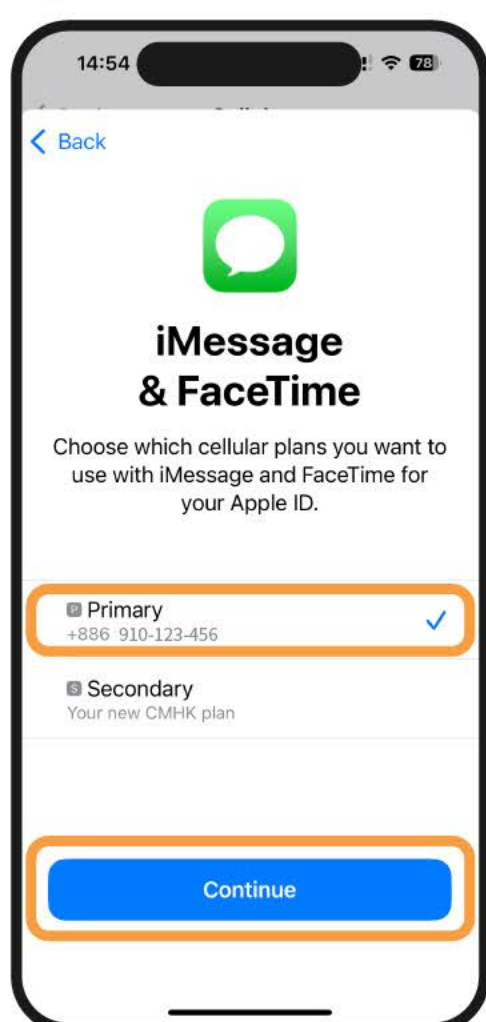

### 8 Cellular Data Choose Primary

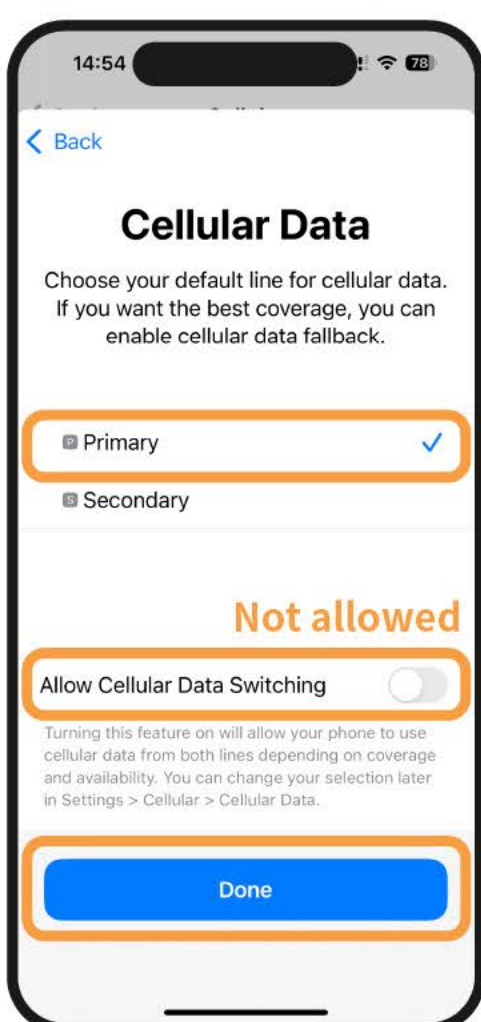

3 more steps  
After arriving at  
the destination



# Arrive the Destination Switch to eSIM and turned on data roaming

### 9 Setting > Cellular > Cellular Data

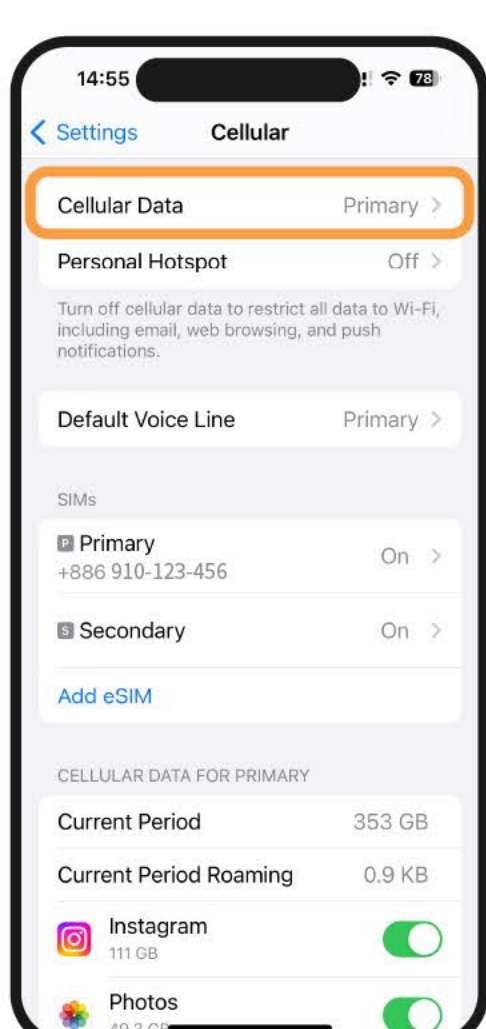

### 10 Cellular data choose secondary

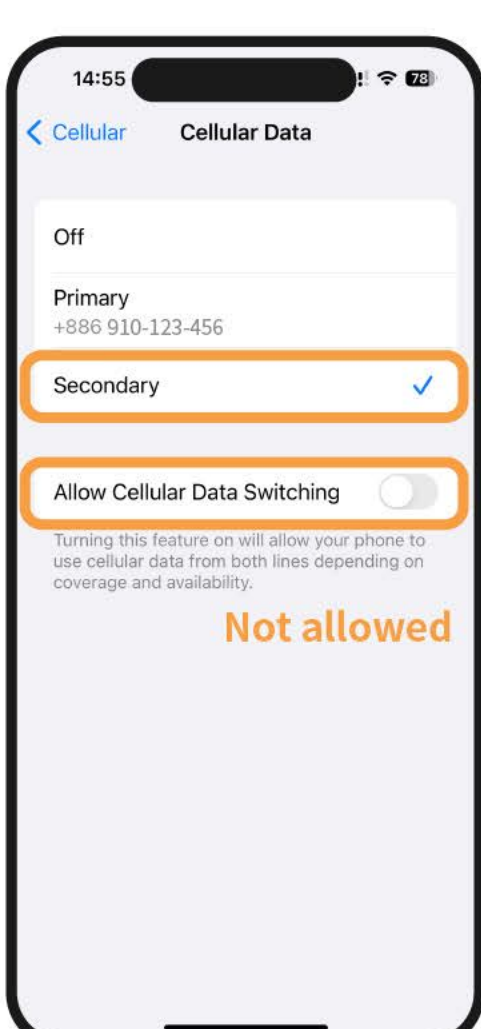

### 11 leave and back to cellular data > turned on data roaming Restart the phone and connect to the network

